

# 2002 48"W McKenzie Alder Bookcase Door Kit

**AEGAC = Glazed Antique Cherry finish; AEGSP = Glazed Spice finish;**

**AECAF = Caffè finish**

*Assembly Instructions*

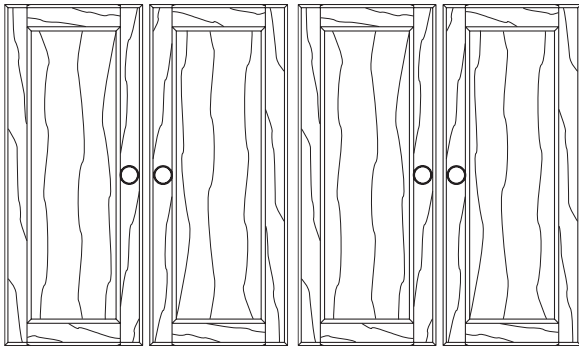

## **IMPORTANT NOTES:**

- For normal household use only. **Not** recommended for commercial use.
- Do not climb, sit or stand on this piece of furniture.
- Before you begin your project, completely read the Assembly Instructions.
- Store this item: 1- in its box; 2- in a dry place; 3- in temperatures that range from 40°F to 90°F (not on a cold and possibly damp cement floor).
- Periodically inspect your furniture for any loose glue joints, screws or any other problem that might affect the stability of your furniture. Tighten or repair as needed.

**DESIGN SUBJECT TO CHANGE WITHOUT NOTICE.**

## **Congratulations!**

*This fine piece of furniture will make a gorgeous addition to your home. For the best results, read the Assembly Instructions before you begin your project.*



**CALL US FIRST!** *Do not return this item to the store.*

**Service Policy:** We will replace any part that is defective, missing or damaged during assembly. Please contact Whittier Wood Products customer service department directly by phone, fax, mail or email for a replacement part.

**Hours:** Our friendly customer service staff can be reached Monday-Friday 7:00 a.m. to 5:00 p.m. (Pacific Time). You may leave a message 24 hours a day, seven days a week.

**To Order:** Designate the finish, provide the furniture model number found in the upper left corner of this page, the part letter, production code, quantity needed, reason for replacement, your full name, address and telephone number.

*Parts ship from our Eugene, Oregon factory within one or two business days from the time we receive your request. Please allow five to ten business days for delivery.*

**800-653-3336** • Outside the U.S. or Canada: 541-687-0213 • Fax: 541-687-2060  
www.whittierwood.com • P.O. Box 2827 • Eugene, Oregon 97402, U.S.A.

**Whittier  
Wood**  
FURNITURE

P.O. Box 2827  
Eugene, OR 97402 USA

Production Code:

02/10

# Glazed Antique Cherry finish (AEGAC) & Glazed Spice finish (AEGSP) & Caffè finish (AECAF) 2002 48"W Door Kit — Parts List

Before you begin to assemble this unit, identify each part and make sure the quantities received match what is on this list.  
If you need to replace a part, please refer to the following list for the part name and letter code.

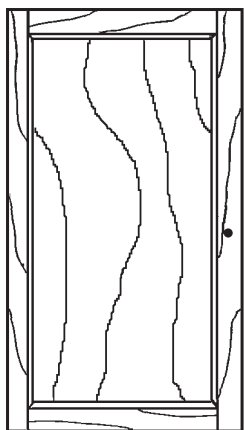

A — Door — Qty. 4

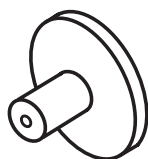

B — Door Knob — Qty. 4



C — #8x1-1/2" Machine Screw — Qty. 4

NOTE: The curve is taller on this piece than the Vertical Panel Hinge.

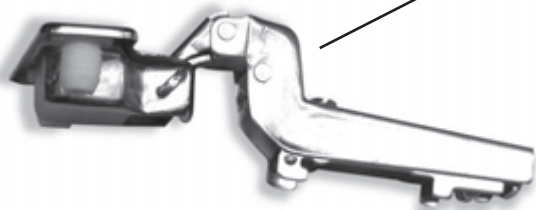

D — Side Panel Hinge — Qty. 4



E — Hinge Plate — Qty. 8



F — Pad — Qty. 4



G — Vertical Panel Hinge — Qty. 4



H — Washer — Qty. 8



Top view of Side Panel Hinge (D) & Vertical Panel Hinge (G)

# Glazed Antique Cherry finish (AEGAC) & Glazed Spice finish (AEGSP) & Caffè finish (AECFAF) 2002 48" W Alder Bookcase Door Kit — Assembly Instructions

Tool required: Phillips Screwdriver

---

1. Add washers to four of the eight Hinge Plates (E). You will attach the Vertical Divider Hinges (G) to these Hinge Plates (E)/Washers (H) assemblies. See Figures 1a, 1b and 1c.

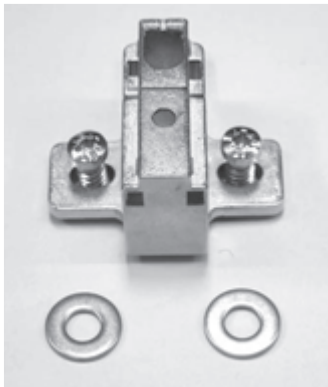

Fig. 1a



Fig. 1b



Fig. 1c

---

2. Snap the handle of the Hinge (D or G) down on to each of the Hinge Plates (E or E/H) as seen in Figures 2 and 2a.

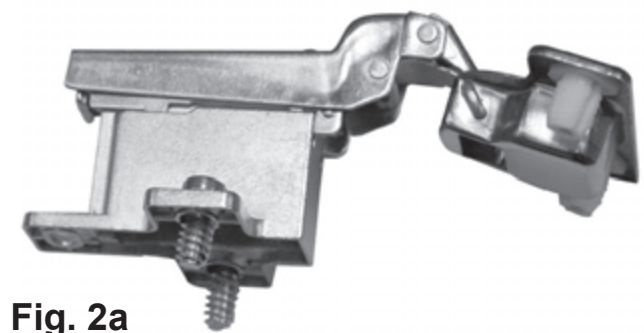
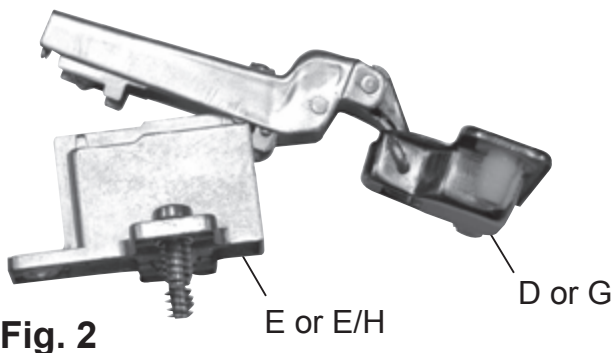

3. Lay two Doors (A) face down on a clean, protected surface. There are predrilled holes in the doors as shown in Figure 3. This is where you will be inserting the hinge part of the assembly. Insert the Side Panel Hinge (D) assembly that has the plastic knobs into the predrilled holes in the bottoms and tops of the Doors (A). See Figures 3 and 3a. **You must place both Side Panel Hinges (D) into the Doors before you attach the doors to the bookcase.**

Fig. 3

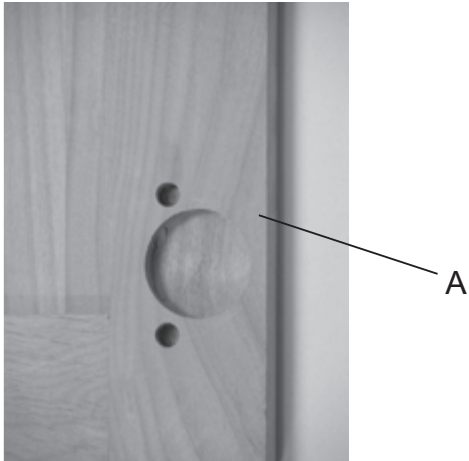
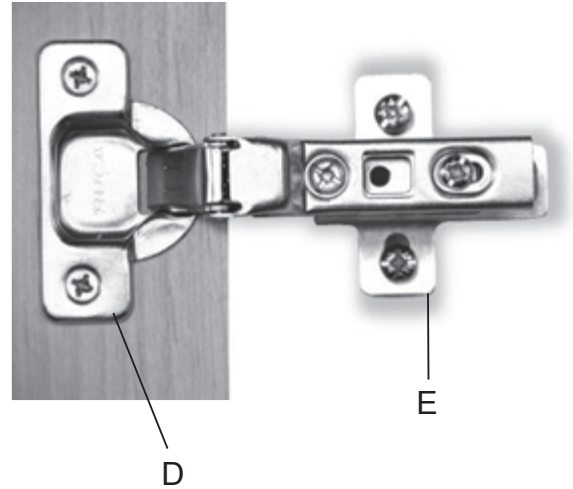

Fig. 3a



- 
4. Lay the other two Doors (A) face down on a clean, protected surface. There are predrilled holes in the doors as shown in Figure 4. This is where you will be inserting the hinge part of the assembly. Insert the Vertical Divider Hinge (G) assembly that has the plastic knobs into the pre-drilled holes in the bottoms and tops of the Doors (A). See Figures 4 and 4a. **You must place both Vertical Divider Hinges (G) into the Doors prior to attaching to bookcase.**

Fig. 4

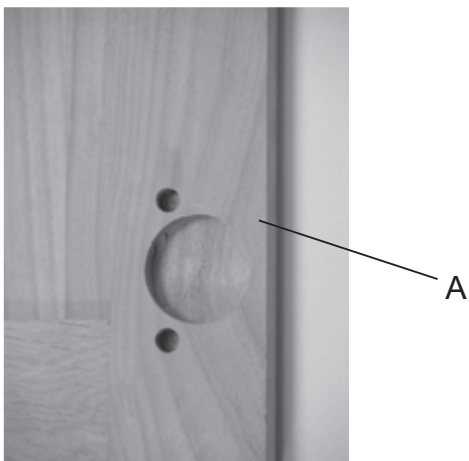
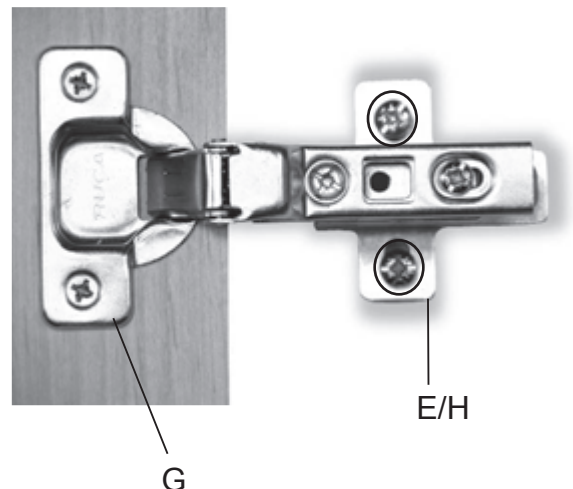

Fig. 4a

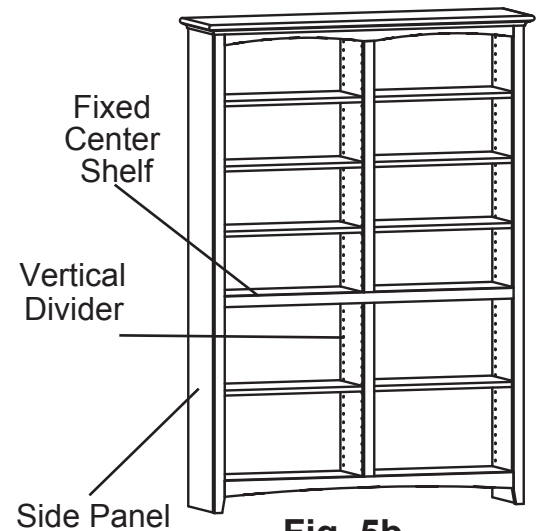



**Fig. 5** Bottom



**Fig. 5a** Center Shelf

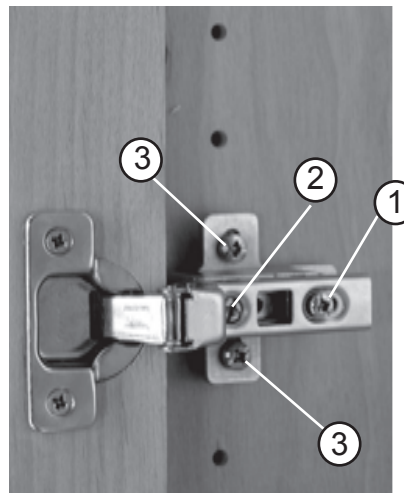

**Fig. 5b**

5. Attach the door with the Side Panel Hinges (D) to the side panels of the bookcase (see Fig. 5b) by inserting the screws in the Hinge Plate (E) into the second and third holes up from the bottom of the bookcase unit. See Figure 5. Attach the second Side Panel Hinge assembly to the same door/bookcase by inserting screws into the third and fourth predrilled holes down from the top of the fixed centered shelf. See Figure 5a. Repeat the steps for other side.

Attach doors with Vertical Divider Hinges (G) and Washers (H) to each side of the vertical divider of the bookcase in the same manner.

6. The door may need to be adjusted so that all the spaces between the doors and unit sides are equal. To make those adjustments, follow the instructions below. See Figure 6.



**Fig. 6**

- Side adjustment** To move the door towards the side panel/vertical divider, rotate screw '2' counter-clockwise. To move it away, rotate screw '2' clockwise.
- Depth adjustment** Loosen screw '1' and adjust door. Re-tighten screw.
- Height adjustment** Loosen screws '3' and adjust door. Re-tighten screws.

7. Attach the Knobs (B) to the Doors (A) with #8x1-1/2 " Machine Screws (C). See Figure 5.

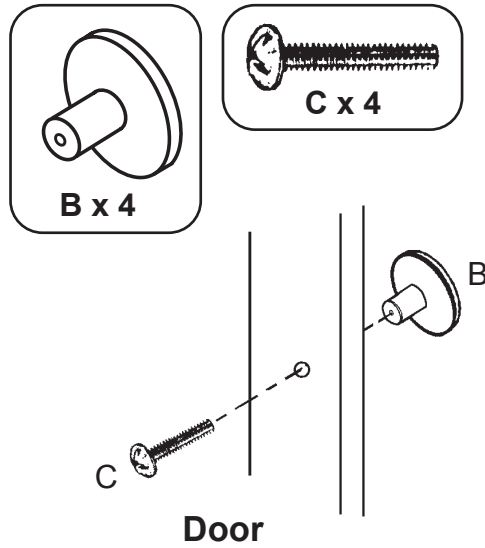

Fig. 7

---

8. Attach a Pad (F) to the back of each door where it comes in contact with the adjustable shelf.

